

COMMISSIONERS RECORD 47
FRANKLIN COUNTY
Commissioners' Proceeding for August 30, 2006

The Honorable Board of Franklin County Commissioners met on the above date. Present for the meeting were Neva J. Corkrum, Chairman; Bob Koch, Chair Pro Tem; and Frank H. Brock, Member; Fred Bowen, County Administrator; and Mary Withers, Clerk to the Board.

OFFICE BUSINESS

Secretary Patricia Shults and Kendra Simpson, Program Specialist, Department of Human Services, met with the Board. Present in audience: Rosie H. Rumsey and Marianne Ophardt.

Consent Agenda

The Board requested an explanation from Ms. Simpson regarding the contracts presented on the consent agenda. After she gave an explanation, Ms. Simpson asked if the Board would be comfortable signing the document, then having an addendum prepared to address the Board's concerns. The Board is not willing to do so. Ms. Simpson will work on the contracts further.

The Board does not have questions about the Diaz agreement. However, they asked to wait to approve either agreement at this time.

Consent Agenda (Clerk's Note: There was no Board action taken on the Consent Agenda.)

1. Approval of **Resolution 2006-__** for a Professional Services Agreement between Clegg & Associates, Agreement #C&A080106, and Benton-Franklin Counties to facilitate a participatory process that produces recommendations and associated implementation plans for quality improvements in key components of the Benton and Franklin Counties behavioral health system, effective August 1, 2006 through December 31, 2006, and authorizing the Chairman to sign said agreement on behalf of the Board.
2. Approval of **Resolution 2006-__** for a Professional Services Agreement between Diaz & Associates, Agreement #D&A072006, and Benton-Franklin Counties, for Diaz & Associates to prepare for mental health system mapping services for Benton and Franklin Counties, effective August 15, 2006 through August 14, 2007, and authorizing the Chairman to sign said agreement on behalf of the Board.

COMMISSIONERS RECORD 47
FRANKLIN COUNTY
Commissioners' Proceeding for August 30, 2006

Vouchers/Warrants

Motion – Mr. Brock: I move for approval of payment of Current Expense warrants 52609 through 52620 in the amount of \$28,978.45. Second by Mr. Koch. 3:0 vote in favor. (Exhibit 1)

Food Services Contract

Motion – Mr. Brock: I move the approval of Resolution 2006-428 as specified: Food Services Contract between the Juvenile Justice Center and Aramark Correctional Services, for a term commencing September 1, 2006 through June 30, 2007. Second by Mr. Koch. 3:0 vote in favor. (Exhibit 6 is the Information Sheet and the Request for Supplemental Appropriation, \$30,648.)

EXTENSION OFFICE

Marianne Ophardt, Benton County Extension Office Director, and Kay Hendrickson, Franklin County Extension Director, met with the Board.

Department Update

Gwen-Alyn Hoheisel has been hired as an Extension faculty member for horticulture. Ms. Ophardt told the Board about the need for a horticulture specialist.

Ms. Ophardt continues to administer the Master Gardener program. She invited the Board to view the rose garden which is located at the Mid-Columbia Library in Kennewick. The program includes both counties.

Ms. Ophardt is on a state Community Forestry Council representing Benton and Franklin Counties. The trees include the urban trees in this area and relates to livability of communities. There is also a Mid-Columbia Forestry Council. Ms. Ophardt said we would like to have more participation on that council. Ms. Ophardt also works with firefighting plans, regarding plantings to help lessen fire dangers.

Ms. Hendrickson said we are on step 2 of an 11-step system to fill the open agronomy position. We have received approval to fill the position. The search committee will convene on September 21 at 9:00 a.m.

MINUTES

COMMISSIONERS RECORD 47
FRANKLIN COUNTY
Commissioners' Proceeding for August 30, 2006

Motion – Mr. Koch: I move the approval of Commissioner Meeting minutes for August 21 and 28, 2006. Second by Mr. Brock. 3:0 vote in favor.

Mr. Brock left the meeting to attend a luncheon.

PUBLIC WORKS

Engineer Tim Fife met with the Board. Present in audience: Boyd Gray.

Resolution: Acceptance of Bosch Court and that portion of Dradie Street as shown in the plat of Bosch Estates II and declaring them county roads

Mr. Fife explained the work that has been done on the streets listed.

Motion – Mr. Koch: I move for the acceptance of Bosch Court and that portion of Dradie Street as shown in the plat of Bosch Estates II and declaring them county roads. This is Resolution 2006-429. Second by Mrs. Corkrum. 2:0 vote in favor.

Motion – Mr. Koch: I move that we release the rights to Certificate #02-90037581 for Bosch Estates II plat. Second by Mrs. Corkrum. 2:0 vote in favor.

Rural Arterial Program (RAP)

The county can submit up to \$8 million worth of projects asking for RAP funding. Mr. Fife said we're going to submit two projects. However, it is not likely that either one will be funded because of the Road 100 extension project and/or the need for emergency funds for the R-170 slide area roadway.

The county can put additional points on one of the two projects. Mr. Fife would like to put the additional points on the Dent Road project between Taylor Flats and Road 100. The study that was done as part of the process of extending Road 100 showed that once Road 100 is extended, Dent Road will be too narrow.

The second project is another phase of the Pasco-Kahlotus Road beyond where we are now, between Murphy Road and McClenny Road.

Motion – Mr. Koch: I move that we authorize the Commission chair to sign Rural Arterial Program Prospectuses for Dent Road plus the intersection and part of the Pasco-Kahlotus Highway. Second by Mrs. Corkrum. 2:0 vote in favor. (Exhibit 2)

R-170 Landslide Area

COMMISSIONERS RECORD 47
FRANKLIN COUNTY
Commissioners' Proceeding for August 30, 2006

Mr. Fife gave the Board an update about the R-170 studies. He said more in-depth surveying and public involvement will be needed so we can make a decision on what route to take. He has received information from a state agency that causes him to believe that the state will provide some Federal funding that is available for the state to disburse for the roadwork.

Mr. Koch would like to meet with legislators to show them the landslide area before they go back to Washington, D.C., and/or Olympia.

Roads

Glade North Road has been closed since Monday at Fir Hill because of road construction.

Cypress Road had to be closed because of a water problem. Cypress Drive is open. The water problem is partially caused by leakage from a canal. In addition, a valve remained open for a long period of time.

PROSECUTOR

Chief Civil Deputy Prosecutor Ryan Verhulp met with the Board. Present in audience: Boyd Gray.

Executive Session at 9:49 a.m. for potential litigation expected to last 20 minutes, under RCW 42.30.110(1)(i). Mr. Gray left the meeting.

Open Session at 10:14 a.m. Boyd Gray and Troy Woody joined the audience.

Recessed at 10:15 a.m.

Reconvened at 10:19 a.m.

TRAC

TRAC Manager Troy Woody met with the Board. Present in audience: Boyd Gray and Mike Corcoran.

Capital 2006 needs

Mr. Woody reviewed information about capital needs for TRAC.

The ice teams have asked Mr. Woody if the ice rink can be used year-round. The existing ice rink cannot be used because it will not work out math-wise. There are a few buildings already existing that may be used including the former Desert Ice rink. The

COMMISSIONERS RECORD 47
FRANKLIN COUNTY
Commissioners' Proceeding for August 30, 2006

Tri-Cities Amateur Hockey Association (TCAHA) has committed to pay about \$250,000 a year on a five-year contract. That is about \$150,000 more than they are paying now. The Titans hockey group may also participate, paying an additional amount. A full-time manager would be hired. Mr. Woody would recommend having any concessions handled by TCAHA. Mr. Woody's figures show an estimate of an additional \$30,000 in profit over what we are doing now. If a different ice rink was used, there would then be no further set-up or tear-down of the ice rink at the Pavilion. The rink would be built on sand. We would use the existing equipment. These are preliminary figures only. Mr. Woody feels it might be worth looking at. The incremental revenue and growth from being able to rent the Pavilion for things other than ice events is not included in the figures.

Mr. Bowen asked if the Board wants to pursue this idea. Mrs. Corkrum said she does not want to pursue building a building and taking up more space at TRAC's property but would like to look at this idea, at least preliminarily.

Mr. Bowen said if this is something that the Board is interested in, he thinks the next step is to find out if the building is even available. The Board members said we have invested quite a bit in equipment. The Board would be interested to find out if the building is available and what the price would be. Mr. Koch asked if there is enough space in the six-acre spot to put a building. Mr. Bowen thinks directly west of the area would be better. He feels it wouldn't disrupt the designs that are already in place. Mr. Koch does not want to take away some grassy area for parking but there is a corner that is an odd shape. He doesn't know how big of a building is needed. Mr. Bowen said the existing Pavilion is 25,000 square feet which includes office space. Mr. Koch asked if that is enough room for what is used now. Mr. Woody said yes. Mrs. Corkrum said she would say build it a little bit bigger.

2006 Capital Requests

Mr. Woody asked the Board to review a list of capital budget requests for 2006. The first of the items are for food and beverage equipment. Mr. Bowen said there is \$16,000 remaining of the bond money that can be used. He said the Board earlier had an

COMMISSIONERS RECORD 47
FRANKLIN COUNTY
Commissioners' Proceeding for August 30, 2006

informal agreement with Mr. Woody that if there is anything left under the subsidy cap for 2006, it can be spent. Mrs. Corkrum said Mr. Woody won't know that yet and he needs these items now. Mr. Bowen said the only other sources of funds are the Rainy Day fund or the money from the land sale. Mrs. Corkrum said it could be reimbursed if there are extra funds under the subsidy. She thinks the equipment is necessary in order to be in competition with other facilities. Mr. Koch said he agrees with Mrs. Corkrum, that with what we have done with the rest of the building, to make it usable we need to proceed. Mr. Bowen will have a resolution prepared to pay the \$16,000 plus the remainder from the Rainy Day fund. Mrs. Corkrum asked if these are hard and fast figures. Mr. Woody said yes and they include tax and delivery.

Mrs. Corkrum said we will probably wait for some input from Mr. Brock but it can be discussed at the time we do the resolution. The resolution will be put on the regular agenda rather than the consent agenda.

Mr. Woody said the chair carts and table carts will be used in the storage shed. They can be stacked three high.

Future Capital Projects

The Board reviewed a list of capital projects for the future. The list included items projected for 2007, then a three-year plan for 2008, 2009 and 2010; and special projects. Mr. Woody will talk to the Board further about the list next week.

Horse Stall Analysis

The Board reviewed Mr. Woody's stall analysis for 2007. One horse group needs all of the outside stalls plus all of the stalls in the Pavilion. The stalls in the Pavilion have been moved outside permanently so new stalls would be needed. One horse group has committed to paying \$30,000 rental for three years on top of their normal contract. In return, TRAC would not charge the group for stall rental for those stalls for the three years.

Ice Rink: Mr. Woody gave an update regarding preparation of the ice rink for the season.

AUDITOR

COMMISSIONERS RECORD 47
FRANKLIN COUNTY
Commissioners' Proceeding for August 30, 2006

Auditor Zona Lenhart met with the Board. Present in audience: Boyd Gray, Mike Corcoran and Kristy Batayola.

Elections

Logic and accuracy tests are being done in preparation for the primary election. Ms. Lenhart showed the Board a copy of the matrix that is used for the test. Test ballots were reviewed. There are 27 precincts involved.

CLARKTOWN / BENEFICIAL WATER COMPANY

Mike Corcoran of Benton-Franklin Council of Governments (BFCOG) and Kristy Batayola met with the Board.

Planning-Only Grant Application

Mr. Corcoran reviewed information on the application with the Board. The planning grant will be focused around the Clarktown water system. A consultant for Clarktown will do a scenario of potable water and irrigation water and then prepare a combined scenario with the Beneficial water association for potable water. At this time, the water associations can use the water for irrigation and/or fire. The Dixon water association will probably be added to the work eventually. Mr. Corcoran reviewed further information in the grant application. The population data and ethnic data are from 2000 figures.

Motion – Mr. Koch: I move for approval of Resolution 2006-431 in regards to the Applicant/Recipient Disclosure/Update Report – Community Development Block Grant Planning-Only Grant Application for the Clarktown/Beneficial/Dixon Water Associations Project. Second by Mrs. Corkrum. 2:0 vote in favor.

COUNTY ADMINISTRATOR

County Administrator Fred Bowen and Human Resources Director Rosie H. Rumsey met with the Board. Present in audience: Boyd Gray and Jerrod MacPherson.
Facilities Director Position

Ms. Rumsey said because the Hay Group has not yet completed their work for the county regarding salary, wages and classification, the county does not have a new salary matrix in place. For the new Facilities Director position, we're using what we've been

COMMISSIONERS RECORD 47
FRANKLIN COUNTY
Commissioners' Proceeding for August 30, 2006

doing in the past and comparing it to other positions in the county. Ms. Rumsey explained the comparison that has been done. The position has been reviewed by the Classification Review Committee. They recommended that the position be placed at Grade 56 based on other positions in the county of the same type. Mrs. Corkrum asked Mr. Bowen if the Classification Review Committee had any objections. Mr. Bowen said no, he is not aware of any objections. He talked to two of the members personally. A third member signed the approval. Ms. Rumsey explained how the Hay Group will include the position in its entire compensation study.

Motion – Mr. Koch: I move that we approve a new position as a Facilities Director at Grade 56. Mr. Bowen does not anticipate that a new person coming in would go anything past a Step 1. Second by Mrs. Corkrum. 2:0 vote in favor.

Ms. Rumsey left the meeting.

Proposed Facilities Budget for 2006 and 2007

The Board reviewed a proposed Facilities Budget for 2006 and 2007.

Mr. Bowen estimates it would cost about \$11,000 to purchase a used van, trailers and fence using funds from the 2006 budget. There is a used van available to purchase from the Solid Waste Department. Toolboxes will be installed in the van to hold sprinkler repair parts and other tools. Two trailers will need to be purchased. There is a pickup available for the director to use. The van will be used for picking up Work Release people and jail trustees to transport them from the jail to the work sites. Mr. Bowen said there are funds available. A building has been leased from the Port of Pasco to house the Facilities department. Funds have already been transferred to cover the rent for the four remaining months of 2006. Additional funds will be needed for paint and other supplies. Mr. Bowen explained his requests for budget transfers.

Mr. Bowen asked the Board to determine whether they want to hire the new lead grounds technician right away or wait until 2007. Once the position is open, it will be posted and whoever wants to can apply for it. The person who fills the new position will have a chemical license. Mr. Koch asked Mr. Bowen if we approved this change today, what do you foresee getting done this fall? Mr. Bowen said he would like to start

COMMISSIONERS RECORD 47
FRANKLIN COUNTY
Commissioners' Proceeding for August 30, 2006

bringing all the tools together including lawnmowers, garden hoses and sprinklers. He thinks chemical treatments need to be done on the grounds so we can get a handle on weeds before spring. Parking lot work needs to be done. It is possible a new carpenter will need to be hired to work on the Health District building. There are lots of projects that need to be done. Mr. Koch said the people who fill the positions won't be sitting around by any means. As soon as the weather gets adverse, they can move inside. Mr. Bowen said if it's snowing, the grounds people will handle ice melt and snow removal. They can do work inside also such as painting. If needed, they can do floor work but that will not be the main focus. The main focus will be grounds.

The Board wants to proceed. Mr. Bowen will prepare the resolutions.

The proposed budget was reviewed in detail (Exhibit 3). Mr. Bowen answered the Board's questions. Some revenues from other departments will be moved to offset the additional costs. Cleaning supplies and janitorial costs are included for the Health District. If the Health District decides not to use the county to do maintenance work, we lose the revenue but also the costs. There is a \$30,000 amount for lease and rental of the Franklin County Annex.

The jail would pay a management fee of about \$10,542 instead of having a jail captain handle the staff person. The cost is shared by the City of Pasco and other entities that use the jail. Mr. Bowen answered Mrs. Corkrum's questions about how the salary for the person doing work at the jail will be handled. Mr. Bowen explained how the jail costs have been determined and that they will remain in the jail budget. Mr. Koch asked if the jail will be a year behind in picking up the costs. Mr. Bowen said they will be a year behind for the \$10,000 (salary costs) but not for the \$36,000 (maintenance costs). He explained how the TRAC costs will be shared. He explained how the RV Park costs will be shared. Mr. Bowen said the proposed Facilities Budget will not actually increase expenditures for Current Expense.

The Board gave approval for Mr. Bowen to move forward.

OTHER BUSINESS

Planning and Development Department

COMMISSIONERS RECORD 47
FRANKLIN COUNTY
Commissioners' Proceeding for August 30, 2006

Planning Director Jerrod MacPherson met with the Board. Present in audience:
Boyd Gray.

Growth Management Update Grant

Mr. MacPherson asked for Board approval to apply for a \$30,000 grant to update development regulations and the comprehensive plan. The county is eligible to apply for this grant every biennium. A draft of the critical areas ordinance has been prepared. Mr. MacPherson would like to utilize some of the money through this grant process to look at landslides in the county. They are listed as geologically hazardous areas. We need to look at our policies on mapping and how to treat those.

Motion – Mr. Koch: I move that the chairman have authorization to sign the 2005-2007 growth management grant update application. Second by Mrs. Corkrum. 2:0 vote in favor. (Exhibit 4)

Final Approval Short Plat, Fred Olberding

Motion – Mr. Koch: I move for final approval for Short Plat 2006-07. This is Resolution 2006-432. Second by Mrs. Corkrum. 2:0 vote in favor.

VOUCHERS/WARRANTS

Motion – Mr. Koch: I move for approval of Salary Clearing payroll as follows:

Warrants 41037 through 41147 for \$190,699.98; warrants 41148 through 41199 for \$191,157.10; and Direct Deposit for \$224,750.41; for a total amount of \$606,607.49. Second by Mrs. Corkrum. 2:0 vote in favor.

The following information is also included on the cover sheet:

Emergency Management Payroll: Warrants 8178 through 8199 for \$3212.49; warrants 8200 through 8208 for \$3595.28; and Direct Deposit for \$5483.26; for a total amount of \$12,291.03; and

Irrigation payroll: Warrants 11967 through 11981 for \$7664.23; and warrants 11982 through 11989 for \$4541.87; for a total amount of \$12,206.10. (Exhibit 5)

Adjourned at 12:07 p.m.

COMMISSIONERS RECORD 47
FRANKLIN COUNTY
Commissioners' Proceeding for August 30, 2006

There being no further business, the Franklin County Board of Commissioners meeting was adjourned until September 6, 2006.

BOARD OF COUNTY COMMISSIONERS
FRANKLIN COUNTY, WASHINGTON

Chairman

Chairman Pro Tem

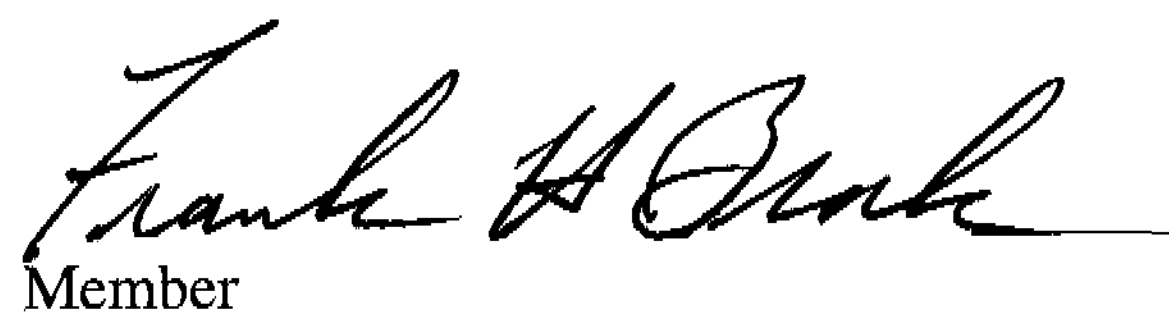
Member

Attest:

Clerk to the Board

Approved and signed September 20, 2006.

EXHIBIT 1
Franklin County Auditor

August 30, 2006

1016 North 4th Avenue
Pasco, WA 99301

ZONA LENHART, Auditor
509-545-3840 • Fax: (509) 545-2142
www.co.franklin.wa.us

P.O. Box 1451
Pasco, WA 99301

August 30, 2006

Franklin County Commissioners:

Vouchers audited and certified by the auditing officer by RCW 42.24.080, expense reimbursement claims certified by RCW 42.24.090, have been recorded on a listing, which has been sent to the board members.

Action: As of this date, August 30, 2006,

Move that the following warrants be approved for payment:



FUND	WARRANT	AMOUNT
Expenditures	Range	Issued
Current Expense	52609-52620	\$28,978.45



In the amount of \$28,978.45. The motion was seconded by
And passed by a vote of 3 to 0

3 to 0

Accounting
545-3505

Elections
545-3538

Recording
545-3536

Licensing
545-3533

2005 - 2007 Biennium

County Road Administration Board
Rural Arterial Program Prospectus

*** IDENTIFICATION:**

Total Rating Points: **67.33**
 Attach Worksheets

SE FRANKLIN

COUNTY: Road Name

FRANKLIN**DENT ROAD + INTERSECTION****10050** Road No.County F&G Class: **T5**

6 Yr TIP

Fed. Funct. Class: **08**Priority No. **18**State Leg. Dist. **16**Map Ref. No. **1****2007-2009**Begin MP **0.00**2nd BMP **varies**For minor leg of
Intersection or
MP Eq'nEnd MP **1.27**2nd EMP **varies**

Attach: Project Narrative
 Rating Worksheets
 Vicinity Map
 Typical Cross Sections

*** DESCRIPTION OF PROPOSED IMPROVEMENTS -**

Deviation Anticipated?

Summary of conditions and proposed improvements the county is claiming
 points for, as well as conditions that will not be improved to design standard.

Condition:

Roadway Structural Section, or Bridge Condition:

Existing roadway width is 26' BST.

Attach Worksheets

Horizontal Alignment:

Horizontal curve at the intersection of Columbia River Road will be improved. The intersection of Dent with Road 68 N., Clark Road, Columbia River Road, and Taylor Flats Road(5 legs) will be improved.

Vertical Alignment:

No existing substandard elements.

Width:

New Road way width will be built 40' wide to comply with projected traffic from the 20 year model results.

Other: Clear Zone, Slopes, Guard. Rail, Illumination, signals etc.

Left turn pocket will be provided at the intersection of Dent and Road 100 Extension. Three existing mail boxes will be replaced with breakaway designs.

*** ESTIMATED FUNDING AND TIMING**

Phase:	Est Total Cost to nearest \$100	ATA Requested	Max ATA	[Est Year]	
				Start	Complete
Design/PE	150,000	135,000	135,000	2007	2009
Right of Way	50,000	45,000	45,000	2008	2009
Construction	1,000,000	900,000	900,000	2010	2010
TOTAL =>	1,200,000	1,080,000			
ATA percent (of eligible costs) =>			90.0%		

*** SPECIAL CONSIDERATIONS THAT MAY AFFECT PROJECT SCHEDULE:**

Wetlands	NMFS	R-O-W	X	Cultural	(Hist. Arch. Paleo.)
Shorelines	USFWS	BIA		Tied	(Other agency work)
USACE	HPA	RR-		Other	(Specify)

*** PROJECT TYPES:**

NE, PS, SE	NE, NW, SE, SW	PS
BRIDGES:	ROADS:	ROADS:
FA or LOCAL	(check project type)	(check project type)
Funding Source: _____ (check one)	3R X	Roadway X
Scope: _____ (check one)	RC	Intersection X
Replace or Rehabilitate		

*** LOCAL PROJECT APPROVAL**

RAP Project Prospectus prepared under the supervision of:

Vic. Map and typical cross sections attached? **X**

RAP Project Prospectus submitted to CRAB with the approval of:

Signature - County Engineer / Date

Signature of Chairman of the Board
 of County Commissioners / Date

ROAD LOG NO. 10050
 COUNTY FRANKLIN
 PROJECT NAME DENT ROAD + INTERSECTION
 SIX YEAR TIP NO. 18
 TODAY'S DATE August 29, 2006

SER RAP **3R** Rating Worksheet
 WAC 136 130 060
 Sheet 1 of 6

3R WORKSHEET RECAP

	Possible Points	Scored Points
TRAFFIC:		
TRAFFIC VOLUME	7	4
TRAFFIC USAGE	5	4
TRAFFIC ACCIDENTS	10	1.43
Subtotal	22	9.43
LOCAL SIGNIFICANCE	20	20
STRUCTURAL CONDITION:		
Surface Condition	5	2
Drainage	5	5
Subsurface or Soils	10	5
*F&G Truck Class	7	8
Subtotal	20	7
GEOMETRY:		
Road Width (shoulder to shoulder)	15	15
Vertical Alignment	5	Reduced
Horizontal Alignment	5	2.90
Subtotal	25	17.90
Widening	Points	
2'	5	
3' - 4'	10	
5' - 8'	15	
3R CHECKLIST: (35 points max.)		
Roadside Safety - Reduce Roadside Hazards		
1 Sideslopes and guardrail	25	0.0
2 Culvert end treatments	5	
3 Remove Structures and Obstructions	15	3
4 Relocate Utility Poles	5	
Subtotal	25	3.00
Intersection Operation - Improvements		
1 Left Turn lanes	10	10
2 Install 36 inch stop sign(s)	2	
3 Rumble pattern buttons for I/S	4	
4 Bring I/S sight distance to standard	6	
5 Flashing lights on stop sign	8	
6 Flashing intersection signal	10	
Subtotal	10	10.00
TOTAL SE 3R RAP WORKSHEET RATING:	122	67.33

NOTES:

1. Points for Visual Rating portion of the STRUCTURAL RATING will be assigned by the RAP Engineer.
2. No points are allowed for conditions which are not going to be improved by the proposed project.

SER RAP **3R** Rating Worksheet
WAC 136 130 060
Sheet 2 of 6

TRAFFIC VOLUME AND USAGE (12 Points Max.)

VOLUME (7 Points Max.) AADT = 419 TRUCK AADT = 42

Note: Use the larger of AADT or Truck AADT. All traffic data shall be adjusted to reflect average annual daily traffic (AADT).

AADT	1-100	101-200	201-300	301-450	451-600	601-750	>750
POINTS	1	2	3	4	5	6	7
Trk AADT	1-10	11-20	21-30	31-45	46-60	61-75	>75

TRAFFIC VOLUME SUBTOTAL 4

USAGE (5 Points Max.)

Is the road used for:	Check if Yes	Points Available	Points Assigned	Use full points if any usage is evident
Agriculture?	X	2	2	
Logging?	0	1		
Industry?	X	1	1	
Recreation?	X	1	1	
		5	4	

TRAFFIC USAGE SUBTOTAL 4

TOTAL TRAFFIC VOLUME RATING 8

TRAFFIC ACCIDENTS (5 Points Max. for Roads - 10 Points Max. for Bridges)

(Reported and Substantiated Unreported Accidents)

(Indicate number of accidents, not number of fatalities, injuries or property damages)

Year	Prop. Damage No. of accidents	Injury No. of accidents	Fatality No. of accidents
2003			
2004			
2005	1		
Subtotal	2	2	0
Factor	x1	x2	x3
=	2	4	0
			= 6 Total

Accident Rate = Total(From Above) / AADT

RATE	0.01	0.02	0.04	0.06	0.08	0.1
POINTS-ROADS	1	2	4	6	8	10
POINTS-BRIDGES	0	2	4	6	8	10

ACCIDENT RATE = TOTAL (From Above)/AADT, = $\frac{6}{419}$ = 0.01432
No. Acc. ADT

TOTAL TRAFFIC ACCIDENT RATING 1.43

STRUCTURAL CONDITION ASPHALT (20 Points Max.)
 (Page to be filled out by RAP Engineer)
 (Intermediate values on scales are acceptable)

SER RAP 3R Rating Worksheet
 WAC 136 130 060
 Sheet 3 of 6

1. SURFACE CONDITION (5 Points Max.)

Excellent	0	▲	Excellent	Tight surface with no slick or porous areas, no cracks or spalling
Good	1		Good	Only minor, localized transverse cracks, slick or porous areas
Adequate	2		Adequate	Minor, localized, longitudinal cracks; rutting, spalling or ravelling; minor seal patching has been required; some transverse cracking
Fair	3		Fair	Small areas that have required patching; larger areas have required seal patching; some longitudinal cracks, spalling, rutting, or ravelling
Marginal	4		Marginal	Several areas that have required moderate to heavy patching; moderate to heavy cracking, spalling, rutting or ravelling
Poor	5	▼	Poor	Large areas that have required asphalt patching and frequent seal coating; heavy cracking, spalling, rutting and/or ravelling.

* Intermediate values are acceptable

2. DRAINAGE (5 pts Max)

Good/Adequate = 0

Fair = 3

Poor = 5

3. SUBSURFACE CONDITION (10 pts Max)

Excellent	0	▲	Excellent	No signs of displacement or settling
Good	4		Good	Minor localized sags along shoulder
Fair	6		Fair	Moderate alligator cracking mid lane, some sags on shoulders and mid lane, minor localized settling
Poor	8		Poor	Large areas of heavy alligator cracking, extensive sagging and settling.
Very Poor	10	▼	Very Poor	Major subgrade deterioration; extensive deep sags and settling; heavy alligator cracking throughout section.

* Intermediate values are acceptable

Surface Condition
 Drainage
 Subsurface Condition

Structural Condition - Paved Only 7

(Note: Round rating to nearest whole number)

SER RAP **3R** Rating Worksheet

WAC 136 130 060

Sheet 4 of 6

STRUCTURAL CONDITION GRAVEL (20 Points Max.)

(Surface Condition and Drainage points to be filled out by RAP Engineer)

(Intermediate values on scales are acceptable)

1. SURFACE CONDITION (2 Points Max) Scored By CRAB

Good	0	▲	Good	Adequate amount of surface material of proper gradation and well fractured.
Fair	1		Fair	Some material but over sized gradation or poorly fractured.
Poor	2	▼	Poor	No surface material, large loose stones, barely travelable.

* Intermediate values are acceptable

If traffic volumes and speed are such that excessive maintenance is required, a maximum rating may be applied.

Visual Surface Score| |from CRAB

2. DRAINAGE (5 Points Max.) Scored By CRAB

Good	0			
Fair	3	Intermediate values are acceptable	Drainage Score	from CRAB
Poor	5			

Total Visual Score| 0 |from CRAB

3. BASE OR FOUNDATION CONDITION (5 Points Max)

Submit Test procedure and/or Data

By Cores: Dig or excavate down 3 ft with backhoe or auger.
Analyze material below surfacing.Points
Possible

Good	1	GRAVEL
	2	SAND
Fair	3	SILT
	4	CLAY
Poor	5	ORGANIC

SELECTED: SCORE:

0

4. TRUCK CLASS RATING (8 Points Max.)

From Road Log

CLASS	SELECT ONE:	POSSIBLE	SCORE
T6 or T7		2	
T5	x	4	4
T4		6	
T3		8	
			4

Visual Rating	0	From CRAB
Base	0	
Truck Rating	4	

TOTAL GRAVEL STRUCTURAL RATING| 4.00 |

SER RAP 3R Rating Worksheet
WAC 136 130 060
Sheet 5 of 6

LOCAL SIGNIFICANCE:

This route is determined to be of highest Local Significance

(Insert a brief description of the local significance of this route/project.)

The entire area was modeled as part of the Road 100/ Dent Road extension project. The traffic model showed that major improvements will be needed for Dent Road between Road 100 Extension and the intersections of Dent/N.Columbia River/Taylor Flat/Road 68 N. as a result of the extension of Road 100. This project would provide those improvements.

20 Points Assigned ☒ (check here if project is of highest local significance)

For each county, only 1 project per biennium is allowed local significance points.

Concurrence by  (Public Works Director or County Engineer /Date)

8-30-06

GEOMETRICS (25 Points Max.)

SER RAP **3R** Rating Worksheet
WAC 136 130 060
Sheet 6 of 6

ROADBED WIDTH

Existing Roadbed Width	Widening:	Points:	Widening	Points
	6	15	2'	5
		15	3' - 4'	10
		15	5' - 8'	15

Cannot be greater than:

32

DESIGN ROADBED WIDTH CALCULATION



COLLECTORS

< 400	400 - 1500	1500 - 2000	> 2000
32	32	34	0
32	32	0	

VERTICAL ALIGNMENT (5 Points Max.)

(Use stopping sight distance standard)

Length of substandard vertical curves in miles, CL	0.00
Project length in miles, PL	1.27
CL/PL	0.00 %

%	0	2	4	6	8	10
POINTS	0	1	2	3	4	5

VERTICAL ALIGNMENT SUBTOTAL **0.00**

HORIZONTAL ALIGNMENT (5 Points Max.)

$$\text{Points} = \left(\sum_n [De - Ds] \right) / 4L$$

Where: De = Degree of Existing Curves
Ds = Degree of Design Standard Curves
L = Length of Project in Miles

1. Do calculation inside brackets for each curve,
2. Sum all the curve deficiencies
3. Divide the total by 4 X project length.

HORIZONTAL ALIGNMENT SUBTOTAL **2.90**TOTAL GEOMETRIC RATING **17.90**

Dent Road + Intersection

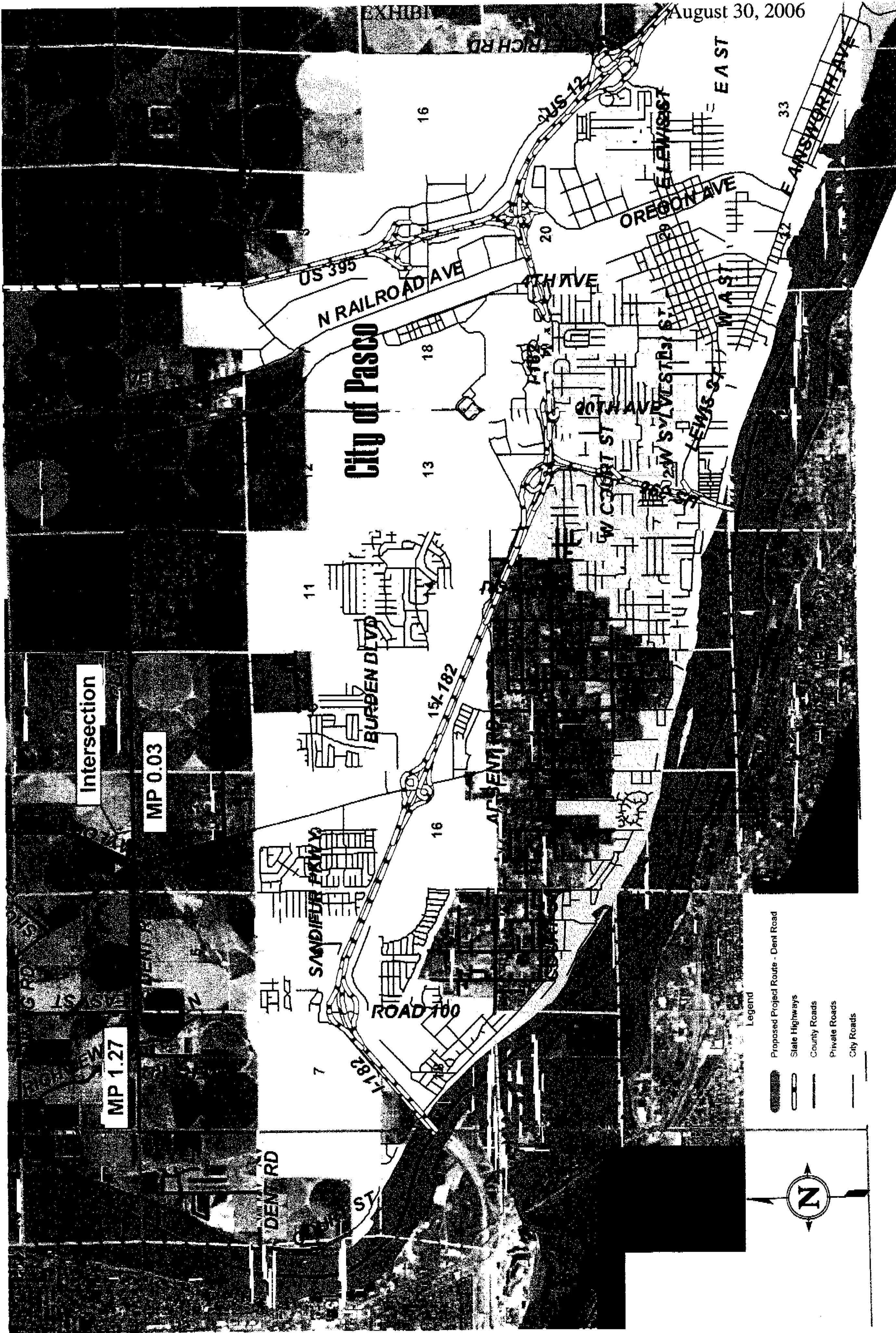

PROPOSED TYPICAL ROADWAY SECTION

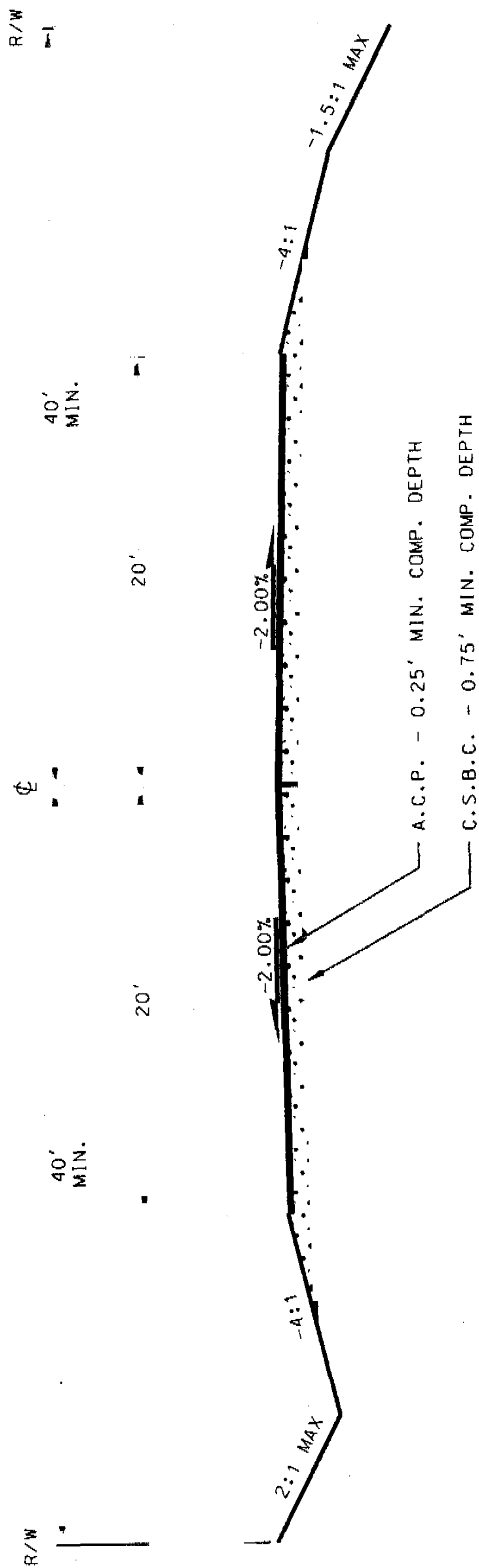

DENT ROAD AND INTERSECTION

2005 - 2007 Biennium

County Road Administration Board
Rural Arterial Program Prospectus

* IDENTIFICATION:

Total Rating Points: 29.39
 Attach Worksheets

SE Franklin

COUNTY: Road Name

Franklin **Pasco-Kahlotus Road 2** **08070** ◀ Road No.

County F&G Class: **T3** 6 Yr TIP
 Fed. Funct. Class: **07** Priority No. **16**
 State Leg. Dist. **16** Map Ref. No. **1**

2007-2009

Begin MP **15.40** 2nd BMP
 End MP **18.10** 2nd EMP

For minor leg of
 Intersection or
 MP Eq'n

Attach: Project Narrative
 Rating Worksheets
 Vicinity Map
 Typical Cross Sections

* DESCRIPTION OF PROPOSED IMPROVEMENTS -

Deviation Anticipated?

▼ Condition: Summary of conditions and proposed improvements the county is claiming points for, as well as conditions that will not be improved to design standard.

Roadway Structural Section, or Bridge Condition:

Existing Roadway is a 26' BST.

Attach Worksheets

Horizontal Alignment:

No deficiencies to improve.

Vertical Alignment:

No Deficiencies to improve.

Width:

Proposed roadway will be constructed to 28' wide.

Other: Clear Zone, Slopes, Guard. Rail, Illumination, signals etc.

Built to reconstruction standards.

* ESTIMATED FUNDING AND TIMING

Phase:	Est Total Cost	ATA Requested	Max	[Est Year]	
	to nearest \$100		ATA	Start	Complete
Design/PE	150,000	135,000	135,000	2008	2008
Right of Way	50,000	45,000	45,000	2009	2009
Construction	1,050,000	945,000	945,000	2010	2010
TOTAL =>	1,250,000	1,125,000			
	ATA percent (of eligible costs) =>		90.0%		

* SPECIAL CONSIDERATIONS THAT MAY AFFECT PROJECT SCHEDULE:

Wetlands ☐ NMFS ☐ R-O-W ☒ Cultural ☐ (Hist. Arch. Paleo.)
 Shorelines ☐ USFWS ☐ BIA ☐ Tied ☐ (Other agency work)
 USACE ☐ HPA ☐ RR- ☐ Other ☐ (Specify)

* PROJECT TYPES:

NE, PS, SE
BRIDGES:
 FA or LOCAL
 Funding Source: ☐ (check one)
 Scope: ☐ (check one)
 Replace or Rehabilitate

NE, NW, SE, SW
ROADS:
 (check project type)
 3R ☐
 RC ☒

PS
ROADS:
 (check project type)
 Roadway ☒
 Intersection ☐

* LOCAL PROJECT APPROVAL

RAP Project Prospectus prepared under the supervision of:

Vic. Map and typical cross sections attached? ☒

RAP Project Prospectus submitted to CRAB with the approval of:



 Signature - County Engineer / Date

 Signature of Chairman of the Board
 of County Commissioners / Date

EXHIBIT 2

August 30, 2006

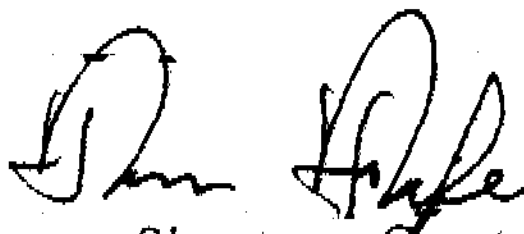
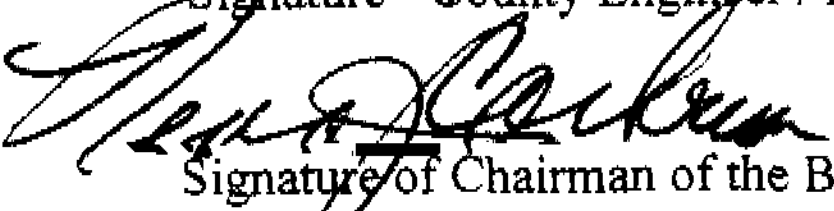
ROAD LOG NO. 8070
 COUNTY FRANKLIN
 PROJECT NAME PASCO_KAHLOTUS 2
 SIX YEAR TIP NO. 16
 TODAY'S DATE August 29, 2006

SER RAP Rating Worksheet
 WAC 136 130 060
 Sheet 1 of 9

WORKSHEET RECAP:

	Possible Points	Scored Points
TRAFFIC		
Volume	7	4.00
Usage	15	9.00
Subtotal	22	13.00
ACCIDENT HISTORY - ROADS	5	0.39
LOCAL SIGNIFICANCE	20	0
STRUCTURAL CONDITION:		
Surface Condition	10	8
Drainage	15	10
Subsurface or Soils	20	15
07 Functional Class for Gravel Road		2
*F&G Truck Class		10
	14	
Subtotal	45 possible	scored
GEOMETRICS ROADS		
Pavement Width	10	
Roadbed Width	10	2.00
Vertical Alignment	5	Reduced 0.00
Horizontal Alignment	5	Reduced 0.00
Subtotal	30	2.00
ACCIDENT HISTORY - BRIDGES	10	
STRUCTURAL CONDITION BRIDGES		
Superstructure Cond.	8	
Substructure Condition	8	
Waterway Adequacy	8	
Structural Condition	16	
Subtotal	40	
GEOMETRICS BRIDGES		
Vertical Clearance	5	
Horizontal Clearance	10	
Vert. Approach Alignment	4	
Horiz. Approach Alignment	5	
Bridge Railing	3	
Approach Guardrails	3	
Subtotal	30	
TOTAL SER RAP WORKSHEET RATING:	122	29.39

Note: -Points for the Structural Condition of Roads will be assigned by the RAP engineer
 -No points are allowed for conditions which will not be improved by the proposed project
 -Proposals below design standards require WSDOT deviation approval.

AADT = 380 TRUCK AADT = 27

AADT	1-100	101-200	201-300	301-450	451-600	601-750	>750
POINTS	1	2	3	4	5	6	7
Trk AADT	1-10	11-20	21-30	31-45	46-60	61-75	>75

TRAFFIC VOLUME SUBTOTAL 4

USAGE (15 Points Max.)		Points	Points
Is the road used for:	Check if Yes	Available	Assigned
Agriculture?	X	7	7
Logging?	0	3	
Industry?	0	3	
Recreation?	x	2	2
		15	9

TRAFFIC USAGE SUBTOTAL	9
------------------------	---

TOTAL TRAFFIC VOLUME RATING 13

(Indicate number of accidents, not number of fatalities, injuries or property damages)

<u>Year</u>	<u>Prop. Damage</u> No. of accidents	<u>Injury</u> No. of accidents	<u>Fatality</u> No. of accidents
2001	1	1	1
2002	1	1	1
2003	2	1	1
Subtotal	3	3	3
Factor	x1	x2	x3

$$= \begin{bmatrix} 3 \end{bmatrix} + \begin{bmatrix} 0 \end{bmatrix} + \begin{bmatrix} 0 \end{bmatrix} = \begin{matrix} 3 \\ \text{Total} \end{matrix}$$
$$\text{Accident Rate} = \text{Total(From Above)} / \text{AADT}$$

RATE	0.01	0.02	0.04	0.06	0.08	0.1
POINTS-ROADS	0	1	2	3	4	5
POINTS-BRIDGES	0	2	4	6	8	10

$$\text{ACCIDENT RATE} = \text{TOTAL (From Above)} / \text{AADT} = 3 / 380 = [0.007895]$$

TOTAL TRAFFIC ACCIDENT RATING	0.39
-------------------------------	------

STRUCTURAL CONDITION ASPHALT (45 Points Max.)
 (Page to be filled out by RAP Engineer)
 (Intermediate values on scales are acceptable)

SER RAP Rating Worksheet
 WAC 136 130 060
 Sheet 3 of 9

1. SURFACE CONDITION (10 Points Max.)

Excellent	0	▲	Excellent	Tight surface with no slick or porous areas, no cracks or spalling
Good	2		Good	Only minor, localized transverse cracks, slick or porous areas
Adequate	4		Adequate	Minor, localized, longitudinal cracks; rutting, spalling or ravelling; minor seal patching has been required; some transverse cracking
Fair	6		Fair	Small areas that have required patching; larger areas have required seal patching; some longitudinal cracks, spalling, rutting, or ravelling
Marginal	8		Marginal	Several areas that have required moderate to heavy patching; moderate to heavy cracking, spalling, rutting or ravelling
Poor	10	▼	Poor	Large areas that have required asphalt patching and frequent seal coating; heavy cracking, spalling, rutting and/or ravelling.

* Intermediate values are acceptable

2. DRAINAGE (15 pts Max) Good/Adequate = 2 Fair = 7 Poor = 15

3. SUBSURFACE CONDITION (20 pts Max)

Excellent	0	▲	Excellent	No signs of displacement or settling
Good	5		Good	Minor localized sags along shoulder
Fair	10		Fair	Moderate alligator cracking mid lane, some sags on shoulders and mid lane, minor localized settling
Poor	15		Poor	Large areas of heavy alligator cracking, extensive sagging and settling.
Very Poor	20	▼	Very Poor	Major subgrade deterioration; extensive deep sags and settling; heavy alligator cracking throughout section.

* Intermediate values are acceptable

Surface Condition
 Drainage
 Subsurface Condition

Structural Condition - Paved Only 14

(Note: Round rating to nearest whole number)

SER RAP Rating Worksheet

WAC 136 130 060

Sheet 4 of 9

STRUCTURAL CONDITION GRAVEL (45 Points Max.)

(Surface Condition and Drainage points to be filled out by RAP Engineer)
 (Intermediate values on scales are acceptable)

1. SURFACE CONDITION (8 Points Max)

Scored By CRAB

Good	0	▲	Good	Adequate amount of surface material of proper gradation and well fractured.
Fair	4		Fair	Some material but over sized gradation or poorly fractured.
Poor	8	▼	Poor	No surface material, large loose stones, barely travelable.

* Intermediate values are acceptable If traffic volumes and speed are such that excessive maintenance is required, a maximum rating may be applied.

Visual Surface Score| |from CRAB

2. DRAINAGE (10 Points Max.) Scored By CRAB

Good	0
Fair	5
Poor	10

Intermediate values are acceptable

Drainage Score| |from CRAB

Total Visual Score| 5 |from CRAB

3. BASE OR FOUNDATION CONDITION (15 Points Max)

Submit Test procedure and/or Data

By Cores: Dig or excavate down 3 ft with backhoe or auger.
 Analyze material below surfacing.

	Points Possible	
Good	3	GRAVEL
	6	SAND
Fair	9	SILT WITH CLAYS
	12	CLAY
Poor	15	ORGANIC

SELECTED: SCORE:

- - -
 - X - 11
 - - -
 11

4. TRUCK CLASS RATING (10 Points Max.)

From Road Log

CLASS	SELECT ONE:	POSSIBLE:	SCORE
T6 or T7	-	4	
T5	-	6	
T4	-	8	
T3	X	10	10
			10

Visual Rating 5 From CRAB

Base 11

Add 2 pts if: F/C = 07 2

Truck Rating 10

TOTAL GRAVEL STRUCTURAL RATING| 28.00 |

SER RAP Rating Worksheet
WAC 136 130 060
Sheet 5 of 9

LOCAL SIGNIFICANCE:

This route is determined to be of highest Local Significance

(Insert a brief description of the local significance of this route/project.)

20 Points Assigned ☒ (check here if project is of highest local significance)

For each county, only 1 project per biennium is allowed local significance points.

Concurrence by
(Public Works Director or County Engineer /Date)

GEOMETRICS (30 Points Max.)

SER RAP Rating Worksheet

WAC 136 130 060

Sheet 6 of 9

- 1 Ratings based on existing conditions and on actual field measurements throughout the project
- 2 You must correct the deficiencies to receive points. If you are granted a deviation by Trans-Aid, that becomes the standard you must correct to.
- 3 All numbers must be rounded to the nearest whole number

PAVEMENT WIDTH (10 Points Max.)

EXISTING WIDTH [26]

Standards: ADT: WIDTH:

0 - 1000	20'
> 1000	22'
> 2000	24'

Deviation	0'	1'	2'	3'	4'	5'	6'
Points	0	2	5	7	8	9	10

PAVEMENT WIDTH SUBTOTAL [0]

ROADBED WIDTH (10 Points Max.)

EXISTING WIDTH [26]

ADT < 400 Deviation 28' STD Points	0'	1' - 2'	3' - 4'	5'	6'		
	0	2	5	7	8		
400 - 2000 Deviation 34' STD Points	0'	1' - 2'	3' - 4'	5' - 6'	7' - 8'	9' - 10'	
	0	2	5	7	8	9	
ADT > 2000 Deviation 40' STD Points	0'	1' - 3'	4' - 6'	7' - 9'	10' - 12'	13' - 15'	16' - 18'
	0	2	5	7	8	9	10

ROADBED WIDTH SUBTOTAL [2]

VERTICAL ALIGNMENT (5 Points Max.)

(Use stopping sight distance standard)

Length of substandard vertical curves in miles, CL [0.00]
 Project length in miles, PL [2.00]
 CL/PL 0.00 %

%	0	2	4	6	8	10
POINTS	0	1	2	3	4	5

VERTICAL ALIGNMENT SUBTOTAL [0.00]

HORIZONTAL ALIGNMENT (5 Points Max.)

Points =

$$\left(\sum_n^1 [De - Ds] \right) / 4L$$

Where: De = Degree of Existing Curves
 Ds = Degree of Design Standard Curves
 L = Length of Project in Miles

1. Do calculation inside brackets for each curve,
2. Sum all the curve deficiencies
3. Divide the total by 4 X project length.

HORIZONTAL ALIGNMENT SUBTOTAL [0.00]

TOTAL GEOMETRIC RATING [2.00]

SER RAP Rating Worksheet
WAC 136 130 060
Sheet 7 of 9

STRUCTURAL CONDITION BRIDGES (40 Points Max.)

SUPERSTRUCTURE CONDITION (8 Points Max.)

- 0 Good Condition. No repairs needed.
- 1 Generally Good Condition. Potential exists for minor maintenance.
- 2 Fair Condition. Potential exists for major maintenance.
- 3 Generally Fair Condition. Potential exists for minor rehabilitation.
- 4 Marginal Condition. Potential exists for major rehabilitation.
- 5 Poor Condition. Repair or rehabilitation required immediately.
- 6 Critical Condition. The need for repair or rehabilitation is urgent.

- 7 Facility should be closed until the indicated repair is complete.
Critical Condition. Facility is closed. Study should determine the feasibility of repair.
- 8 Critical Condition. Facility is closed and is beyond repair.

SUPERSTRUCTURE CONDITION RATING[0.00]

SUBSTRUCTURE CONDITION (8 Points Max.)

- 0 Good Condition No repairs needed
- 1 Generally Good Condition Potential exists for minor maintenance
- 2 Fair Condition Potential exists for major maintenance
- 3 Generally Fair Condition Potential exists for minor rehabilitation
- 4 Marginal Condition Potential exists for major rehabilitation
- 5 Poor Condition Repair or rehabilitation required immediately
- 6 Critical Condition The need for repair or rehabilitation is urgent
Facility should be closed until the indicated repair is complete
- 7 Critical Condition Facility is closed Study should determine the feasibility of repair
- 8 Critical Condition Facility is closed and is beyond repair

SUBSTRUCTURE CONDITION RATING[0.00]

WATERWAY ADEQUACY (8 Points Max.)

- 0 Large well established channel. No hydraulic problems.
- 1 Rock channel. Riprapped or natural slope protection. Alignment perpendicular to bridge. Stream capacity adequate. No scour.
- 2 Rock and gravel channel. Gradual slopes or partially riprapped. Alignment adequate. Stream has minor drift. No scour in the immediate area of bridge.
- 3 Gravel and sand channel. Unprotected but not steep slopes. Minor alignment problem. Stream causes large drift accumulation. Minor scouring at bridge.
- 4 Sand and mud or grass channel. Unprotected steeper slopes. Alignment problem requiring eventual repair. Stream cause large drift and a high flow. Major scouring but no undermining.
- 5 Mud channel. Unprotected steep banks. Stream overflows banks. Drift may damage superstructure. Undermining problems have developed.
- 6 Basically intolerable condition requiring high priority of replacement.
- 7 Immediate repair necessary to put back in service.
- 8 Immediate replacement necessary to put back in service.

WATERWAY ADEQUACY RATING [0.00]

STRUCTURAL CONDITION (16 Points Max.)

$$D\% = \frac{L_d - L_i}{L_d} \times 100$$

Where: D% = Deficiency of Design
 Ld = Design Loading
 Li = Inventory Loading

$$\frac{L_d - L_i}{L_d} = \frac{0.00}{0.00} = 0$$

D% = 0

D%	0	25	35	50	67	75	87	100
POINTS	0	4	6	8	10	12	14	16

STRUCTURAL CONDITION RATING [0]

TOTAL BRIDGE STRUCTURAL CONDITION RATING 0

GEOMETRICS BRIDGES (30 Points Max.)
 This page referenced to the LAG manual

SER RAP Rating Worksheet
 WAC 136 130 060
 Sheet 9 of 9

Pasco-Kahlotus Road 2

August 30, 2006



PROPOSED TYPICAL ROADWAY SECTION

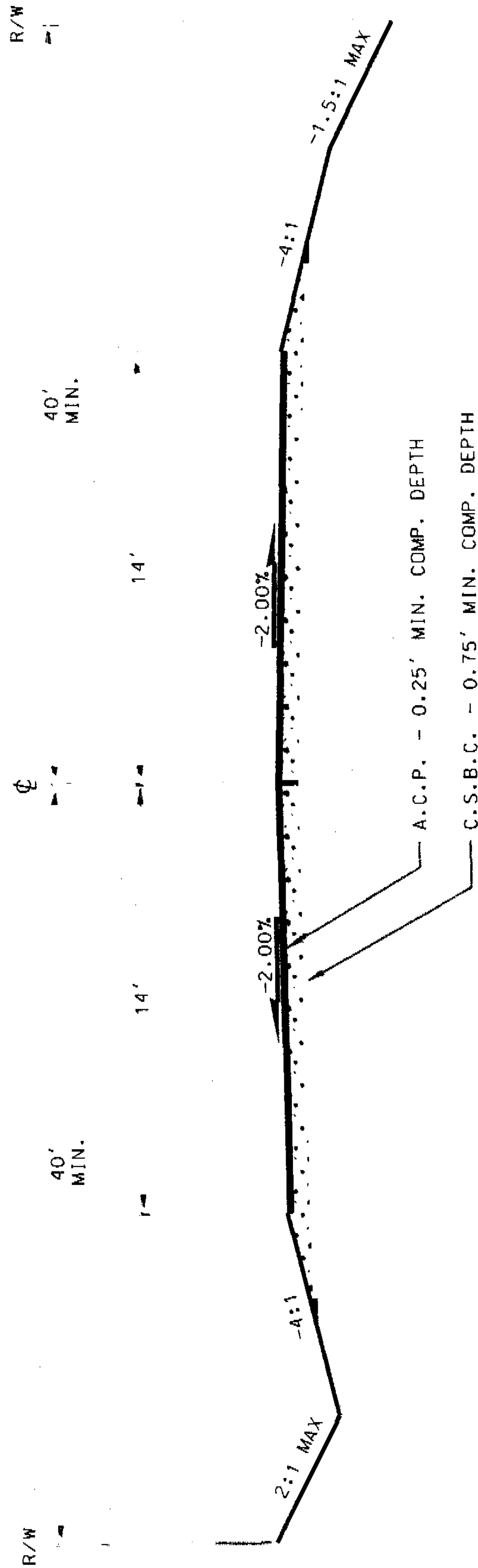

PASCO-KAHL LOTUS ROAD 2

BD044
10.17F R A N K L I N C O U N T Y
BUDGET STATUS REPORTPAGE 1
8/30/06

PERIOD ENDING 8/31/2006

TOTAL APPROPRIATION	Y-T-D EXPENDED	M-T-D EXPENDED	ENCUMBRANCE	UNENCUMBERED BALANCE	% EXP
------------------------	-------------------	-------------------	-------------	-------------------------	-------

001-000-200 COURTHOUSE

518.30.00.0002	567.01			567.01-	
00	567.01			567.01-	
00	567.01			567.01-	

518.30.10.0010 BUILDING SUPERINTENDENT	44,700.00	30,608.00	3,826.00	14,092.00	68.47%
518.30.10.0020 CUSTODIAN	36,546.00	36,859.43	6,066.43	313.43-	100.86%
518.30.10.0030 CUSTODIAN	28,402.00	26,962.10	2,335.00	1,439.90	94.93%
518.30.10.0040 CUSTODIAN	26,974.00	17,897.44	2,222.00	9,076.56	66.35%
518.30.10.0050 CUSTODIAN	28,432.00	18,084.86	2,222.00	10,347.14	63.61%
518.30.10.0060 CUSTODIAN	25,967.00	9,366.57	2,222.00	16,600.43	36.07%
518.30.10.0900 OVERTIME	250.00	956.82		706.82-	382.73%
10 PERSONAL SERVICES	191,271.00	140,735.22	18,893.43	50,535.78	73.58%
10 PERSONAL SERVICES	191,271.00	140,735.22	18,893.43	50,535.78	73.58%

518.30.20.0001 SOCIAL SECURITY	14,633.00	10,766.50	1,445.37	3,866.50	73.58%
518.30.20.0002 MEDICAL & HOSPITAL	42,120.00	33,569.76	4,515.00	8,550.24	79.70%
518.30.20.0003 RETIREMENT	5,634.00	3,652.24	615.19	1,981.76	64.82%
518.30.20.0004 INDUSTRIAL INSURANCE	13,389.00	9,268.75	1,149.44	4,120.25	69.23%
518.30.20.0005 UNEMPLOYMENT	900.00	900.00			100.00%
20 PERSONNEL BENEFITS	76,676.00	58,157.25	7,725.00	18,518.75	75.85%
20 PERSONNEL BENEFITS	76,676.00	58,157.25	7,725.00	18,518.75	75.85%

518.30.31.0000 OFFICE & OPERATING SUPPLIES - CT H	125.00	391.92	6.16	266.92-	313.54%
518.30.31.0001 UNIFORMS	1,000.00	656.40		343.60	65.64%
31 OFFICE & OPERATING SUPPLIES	1,125.00	1,048.32	6.16	76.68	93.18%
518.30.35.0000 SMALL TOOLS & EQUIPMENT	1,595.00	282.35	109.16	1,312.65	17.70%
30 SUPPLIES	2,720.00	1,330.67	115.32	1,389.33	48.92%

518.30.45.0000 OPERATING RENTALS & LEASES	150.00	60.92	1,260.00	89.08	40.61%
518.30.45.0001 BUILDING LEASE	3,150.00	1,260.00	1,260.00	1,890.00	40.00%
45 OPERATING RENTALS & LEASES	3,300.00	1,320.92	1,260.00	1,979.08	40.03%

518.30.48.0001 REPAIRS & MAINTENANCE - PSB	31,387.00	20,448.66	2,886.71	10,938.34	65.15%
518.30.48.0003 REPAIRS & MAINTENANCE - COURTHOUSE	34,094.00	7,036.48	1,771.26	27,057.52	20.64%
518.30.48.0004 REPAIRS & MAINTENANCE - MUSEUM/HEALT	18,135.00	2,868.00	1,732.80	15,267.00	15.81%
518.30.48.0005 REPAIRS & MAINTENANCE - ANNEX	12,000.00	7,785.65	906.87	4,214.35	64.88%
48 REPAIR & MAINTENANCE	95,616.00	38,138.79	7,297.64	57,477.21	39.89%

40 OTHER SERVICES & CHARGES	98,916.00	39,459.71	8,557.64	59,456.29	39.89%
001 000 200 518.30 COURTHOUSE	369,583.00	240,249.86	35,291.39	129,333.14	65.01%
OBJECT 10-29	267,947.00	198,892.47	26,618.43	69,054.53	74.23%
OBJECT 30-99	101,636.00	41,357.39	8,672.96	60,278.61	40.69%
001 000 200 DEPARTMENT TOTAL	369,583.00	240,249.86	35,291.39	129,333.14	65.01%

22,000
10,000
2,000
34,000
-20,000 Director
14,000
-11,000 Capital
3,000

OBJECT 10-29	267,947.00	198,892.47	26,618.43	69,054.53	74.23%
OBJECT 30-99	101,636.00	41,357.39	8,672.96	60,278.61	40.69%
001 000 001 FUND TOTAL CURRENT EXPENSE	369,583.00	240,249.86	35,291.39	129,333.14	65.01%

August 30, 2006

EXHIBIT 3

BD044	F R A N K L I N C O U N T Y				PAGE 2
10.17	BUDGET STATUS REPORT				8/30/06
GRAND TOTAL ALL FUNDS		PERIOD ENDING	8/31/2006		
	TOTAL	Y-T-D	M-T-D	UNENCUMBERED	PCT
	APPROPRIATION	EXPENDED	EXPENDED	BALANCE	
00	MISCELLANEOUS	.00	567.01	.00	567.01-
10	SALARIES & WAGES	191,271.00	140,735.22	18,893.43	50,535.78 73.58%
20	PERSONNEL BENEFITS	76,676.00	58,157.25	7,725.00	18,518.75 75.85%
30	SUPPLIES	2,720.00	1,330.67	115.32	1,389.33 48.92%
40	OTHER SERVICES & CHARGES	98,916.00	39,459.71	8,557.64	59,456.29 39.89%
50	INTERGOVERNMENTAL SERVICES	.00	.00	.00	.00
60	CAPITAL OUTLAY	.00	.00	.00	.00
70	DEBT SERVICE - PRINCIPAL	.00	.00	.00	.00
80	DEBT SERVICE - INTEREST	.00	.00	.00	.00
90	INTERFUND	.00	.00	.00	.00
TOTAL EXPENDITURES		369,583.00	240,249.86	35,291.39 *	129,333.14 *
OBJECT 10-29		267,947.00	198,892.47	26,618.43	.00 74.22%
OBJECT 30-99		101,636.00	41,357.39	8,672.96	.00 40.69%

Neva J. Corkrum
District 1

Robert E. Koch
District 2

Frank H. Brock
District 3

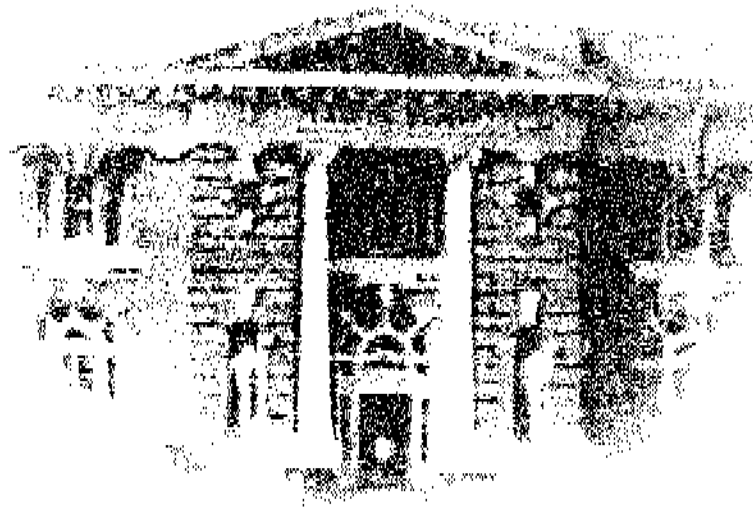

Fred H. Bowen
County Administrator

Rosie H. Rumsey
Human Resources Director

Patricia L. Shults
Executive Secretary

Board of County Commissioners
FRANKLIN COUNTY

August 30, 2006

ATTN: Grants Team
Washington State Department of Community, Trade and
Economic Development / Growth Management Services
P.O. Box 42525
906 Columbia Street Southwest
Olympia, WA 98504-2525

Subject: 2005 – 2007 Growth Management Act Update Grant Application

To Whom It May Concern:

Please find enclosed Franklin County's Growth Management Act Update Grant application for the 2005-2007 biennium.

Franklin County received funding from the previous biennium for Growth Management Act Updates for assistance with meeting the requirements of RCW 36.70A.130. Through that grant process the County was able to update its Comprehensive Plan, and Development Regulations (Zoning Ordinance), along with the development of a Draft Critical Areas Ordinance.

Franklin County wishes to continue in its effort to comply with RCW 36.70A.130 and looks forward to utilizing the 2005-2007 biennium funding in an effort to reach that goal. The following are the areas that Franklin County would like to address for this GMA grant update cycle:

- Specific review and update of its policies and mapping for the Draft Critical Areas Ordinance (Geologically Hazardous Areas - Landslides). Franklin County has experienced some recent landslide activity that has covered and closed a County Road, and caused extensive damage. A review of our current Draft CAO's policies/mapping dealing with this issue is imperative.
- The County also needs to update specific areas of our Development Regulations, such as the Subdivision Ordinance and the Sign Ordinance to be consistent with the Comprehensive Plan.

I would like to thank you for your time and consideration with our application, and if there are any questions, comments and/or concerns feel free to contact me at (509) 545-3535, or our Planning and Building Director, Jerrod MacPherson at (509) 545-3521.

Sincerely,

A handwritten signature in black ink, appearing to read "Neva J. Corkrum". The signature is fluid and cursive, with the first name "Neva" being more prominent.

Neva J. Corkrum, Chair
Franklin County Commissioners

:Enclosure

cc: Jerrod MacPherson, Director of Planning and Building



STATE OF WASHINGTON

DEPARTMENT OF COMMUNITY,
TRADE AND ECONOMIC DEVELOPMENT128 – 10th Avenue SE • PO Box 42525 • Olympia, Washington 98504-2525 • (360) 725-3000**Grant Application**

Growth Management Services
GMA Update Grant for jurisdictions with a
December 1, 2007 deadline for updating comprehensive plans and
development regulations.
(per RCW 36.70A.130)

Applying Jurisdiction	<i>Franklin County, Washington</i>		
Joint Applicants	<i>N/A</i>		
Project Manager	<i>Same as below</i>		
Name	<i>Jerrold MacPherson</i>		
Title	<i>Director</i>		
Department	<i>Planning and Building Department</i>		
Mailing Address	<i>1016 North 4th Avenue</i>		
City	<i>Pasco</i>	<i>WA</i>	<i>ZIP: 99301</i>
Telephone:	<i>(509) 545-3521</i>	<i>Fax: (509) 546-3367</i>	
Email	<i>jmacpherson@co.franklin.wa.us</i>		
Do you wish to receive information and materials via email?	<i>Yes</i>		
Financial Contact	<i>Same as below</i>		
Name	<i>Jerrold MacPherson</i>		
Title	<i>Director</i>		
Department	<i>Planning and Building Department</i>		
Mailing Address	<i>1016 North 4th Avenue</i>		
City	<i>Pasco</i>	<i>WA</i>	<i>ZIP: 99301</i>
Telephone Number	<i>(509) 545-3521</i>	<i>Fax: (509) 546-3367</i>	
Email	<i>jmacpherson@co.franklin.wa.us</i>		
Federal Tax	<i>91-6001315</i>		
Identification Number			
Statewide Vendor			
(SWV) Number	<i>N/A</i>		

Statement of Work

Short Description of Grant *The County is looking to review and update its policies/mapping for a portion of our Draft Critical Areas Ordinance (Geologically Hazardous Areas), due to recent landslide activity that has covered and closed a County Road, causing extensive damage. The County also needs to update specific areas of our Development Regulations, such as the Subdivision Ordinance and the Sign Ordinance for consistency with our Comprehensive Plan.*

Goals/ Actions/ Deliverables	Description	Start Date	End Date
Goal 1	<i>Complete a review and update of our Draft CAO's Geologically Hazardous Areas (Landslides) policies and mapping to reflect some recent landslide activity.</i>	<i>7/1/2006</i>	<i>6/30/2007</i>
Action 1.1	<i>Analyze soil types, slope, and the presence of water and other variables in the areas of recent slides.</i>	<i>10/01/2006</i>	<i>2/28/2007</i>
Action 1.2	<i>Utilize those findings to review our Draft CAO's policies and mapping pertaining to Geologically Hazardous Areas (Landslides).</i>	<i>3/1/2007</i>	<i>4/30/2007</i>
Deliverables	<i>The revision and update of our Draft CAO's policies and mapping to reflect the most current data available in the area of Geologically Hazardous Areas (Landslides).</i>	<i>5/1/2007</i>	<i>6/30/2007</i>
Goal 2	<i>Complete a review and update of our Development Regulations (Subdivision Ordinance).</i>	<i>11/1/2006</i>	<i>3/30/2007</i>
Action 2.1	<i>Analyze our existing Development Regulations (Subdivision Ordinance) for consistency with the Comprehensive Plan and State and Local laws.</i>	<i>11/1/2006</i>	<i>1/31/2007</i>
Deliverables	<i>Utilize those findings for the revision and update of our existing Development Regulations (Subdivision Ordinance) for compliance with the GMA, our Comprehensive Plan and other State and Local laws.</i>	<i>2/1/2007</i>	<i>3/30/2007</i>

Goal 3	<i>Complete a review and update of our Development Regulations (Sign Ordinance).</i>	4/02/2007	6/30/2007
Action 3.1	<i>Analyze our existing Development Regulations (Sign Ordinance) for consistency with the Comprehensive Plan and State and Local laws.</i>	4/02/2007	5/15/2007
Deliverables	<i>Utilize those findings for the revision and update of our existing Development Regulations (Sign Ordinance) for compliance with the GMA, our Comprehensive Plan and other State and Local laws.</i>	5/15/2007	6/30/2007

To insert an additional line, highlight the last row, select Table from the main menu, then Insert > Row Below.

IMPORTANT: In order to receive all your grant money in the current biennium, all deliverables and actions for both the comprehensive plan and Critical Areas work included in the Statement of Work above should not have an End Date beyond 06/30/07

Budget

	Total July 1, 2006 to June 30 2007
EXPENSES	
Salaries and Benefits	\$28,000.00
Goods and Supplies	\$1,000.00
Professional Services	N/A
Other Goods and Services	\$1,000.00
Total	\$30,000.00
REVENUE	
CTED Grant Funds	\$30,000.00
Other Funds	N/A
Total	\$30,000.00

*Note: Any information we have sent to you will soon be available at the CTED website: www.cted.wa.gov/growth.

August 31, 2006

Franklin County Commissioners:

Vouchers audited and certified by the auditing officer by RCW 42.24.080, expense reimbursement claims certified by RCW 42.24.090, have been recorded on a listing, which has been sent to the board members.

Action: As of this date, 08/31/2006

move that the following warrants be approved for payment.

FUND	WARRANT	AMOUNT
Salary Clearing Payroll:		
	41037-41147	190,699.98
	41148-41199	191,157.10
	Direct Deposit	224,750.41
	Total	\$606,607.49

In the amount of \$ **606,607.49** . The motion was seconded by

and passed by a vote of *2* to *0* .



Emergency Mgmt Payroll:

8178-8199	\$3,212.49
8200--8208	3,595.28
Direct Deposit	5,483.26
Total	\$12,291.03

Irrigation Payroll:

11967-11981	\$7,664.23
11982-11989	\$4,541.87
Direct Deposit	0.00
Total	\$12,206.10

AGENDA ITEM: Consent

MEETING DATE: B/C 08-28-06 F/C 08-30-06

SUBJECT: Signature on Contract with
ARAMARK Correctional Services

Prepared By: Kathryn M. Phillips

Reviewed By: Sharon Paradis

TYPE OF ACTION NEEDED

Executive Contract xx
Pass Resolution xx
Pass Ordinance
Pass Motion
Other

CONSENT AGENDA xx
PUBLIC HEARING
1ST DISCUSSION
2ND DISCUSSION
OTHER

BACKGROUND INFORMATION

On June 27, 2006 the Benton and Franklin Counties Boards of Commissioners approved that we move forward with a contract for detention food services with ARAMARK Correctional Services.

SUMMARY

This contract provides for food services to the Benton-Franklin Counties Juvenile Justice Center, Detention Unit, to be prepared by ARAMARK in the detention kitchen.

RECOMMENDATION

We recommend that the Boards of County Commissioners approve the Food Services Contract between the Benton-Franklin Counties Juvenile Justice Center and ARAMARK Correctional Services, as written.

FISCAL IMPACT

This fiscal impact for 2006 has been addressed in a budget supplement request from carry forward funds. The 2007 impact will be addressed in the proposed 2007 budget.

MOTION

I move that the Chairman of the Board of Benton County Commissioners and the Chairman of the Board of Franklin County Commissioners be hereby are authorized to sign, on behalf of their respective county, the Food Services Contract between ARAMARK Correctional Services and the Benton-Franklin Counties Juvenile Justice Center.

Commissioners' Date Stamp:

TRANSMITTAL**REQUEST FOR SUPPLEMENTAL APPROPRIATION**

Fund Name:	Juvenile	Fund Number:	0115-101
Dept Name:	Contract Fee for Service	Dept Number:	173

Request Summary

Expenditure		Supplement	Revised Budget
BARS Number	Item Name	Amount	
527.400.4103	Professional Services	\$12,648	\$105,978
594 273.6401	Capital Equipment	\$18,000	\$18,000
Total Supplement		\$30,648	

Revenue		Amount
Fund Number	Item Name	
334.04.6051	BECCA (Fee for Service Carry Forward)	\$30,648
Total Revenue		\$30,648

Basis for Supplement (Attach Documentation as Appropriate):

Both Boards of County Commissioners approved the Juvenile Department to move forward with a contract with ARAMARK to supply on-site Juvenile Detention food services. This supplement covers costs for four months effective September 1, 2006 through December 31, 2006.

Commissioners**Benton County**Approved for Hearing ☒Denied ☐

CHAIRMAN

COMMISSIONER

COMMISSIONER

Commissioners**Franklin County**Approved for Hearing ☒Denied ☐

CHAIRMAN

COMMISSIONER

COMMISSIONER